

## SPORTS EQUIPMENT

DAILY (Mon-Fri) SAT-SUN

Dodge Ball Set (6 balls & 12 Orange cones)	\$8	\$10
Sports Box (Choose any 5 items below)	\$20	\$30
Bean Bag Toss/Corn-Hole	\$5	\$7
Horseshoe Set	\$5	\$7
Kickball, Throw-Down Bases	\$3	\$5
Volleyball Set	\$5	\$7
Tug of War Rope	\$5	\$7
Flag-Football Set	\$5	\$7
Jumbo Bowling	\$5	\$7
Jumbo Checkers	\$5	\$7
3 in 1 Checkers	\$3	\$5
Kan Jam	\$5	\$7
Mini Kan Jam	\$3	\$5
Yard Dice	\$5	\$7
Soccer Ball or Basket Ball	\$3	\$5

## BIKES

Mountain Bicycle (Vest & Helmet included)	\$10	\$15
--	------	------

## DUNKING BOOTH

Dunking Booth with Trailer	\$100	\$120
----------------------------	-------	-------

## INFLATABLES

Cleaning/Damage Deposit \$75.00

All are heavy; recommend 3-4 people for loading/unloading

15 Foot Dry Slide	\$90	\$150
EZ Sports Combo 28x13x14	\$105	\$200
Palm Tree Bounce House 15x15x14	\$90	\$150
Bounce House Combo	\$105	\$200
Fun House Bounce House	\$90	\$150



## HUNTING EQUIPMENT

DAILY (Mon-Fri) SAT-SUN

Hunting Blind	\$5	\$10
Tree Climbing Stand	\$5	\$10
Genesis Bow	\$5	\$10
Mission Bow (Hunting) with scope	\$15	\$25

## RENTAL POLICIES

**Reservation Policy:** Reservations may be made up to two months (60 days) in advance. Full payment is required for all reservations to be held. Payment can be made over the phone by a credit card or in person with a check, cash, or credit card. All rental items must be returned cleaned and in the same condition they were accepted in.

**Reservation Refund Policy:** Full refunds will be offered for cancellations up to 2 days prior to reservation pick-up. Cancellations within 2 days of reservation pickup will result in forfeiture of the first day's rental fees for all items.

**Late Returns:** The charge for equipment returned late is 1.5 times the daily rate.

All rentals are due back in 30 minutes before closing. No rentals 30 minutes before closing.

Fuel (gasoline & propane) is the responsibility of the renter.

**\*\*All boat/motor rentals require customer to complete a Boater Safety Course and show certification card which can be completed at: <http://www.boatus.org/southcarolina/>**

Reservation Prices & Rates subject to change without notification.



Visit us on the web at:

<http://jackson.armymwr.com/us/jackson/programs/marion-st-station>

Facebook:

[www.facebook.com/Fort-Jackson-MWR-Outdoor-Recreation-Program](http://www.facebook.com/Fort-Jackson-MWR-Outdoor-Recreation-Program)



Fort Jackson

# OUTDOOR RECREATION

## 2021 Price List

## HOURS OF OPERATION

Monday & Tuesday: 10 a.m. - 5 p.m.

Thursday & Friday: 10 a.m. - 5 p.m.

Saturday: 9 a.m. - 3 p.m.

Wednesday & Sunday: Closed

4522 Marion Ave.  
Fort Jackson SC 29207

Phone: 803.751.3484

Fax: 803.751.3485

Current as of 9/27/21

BOATS

(\$200 deposit on all Gas power boats)

All boat rentals for fresh water only. Boaters' Education Card required.  
All boats equipped with personal flotation devices (PFDs) for the boat's capacity.

	DAILY (Mon-Fri)	SAT-SUN
Jon Boat-with trolling motor & battery	\$30	\$40
Camo Boat-25 hp	\$40	\$50
40 hp	\$50	\$60
Bass tracker Boat-20 hp	\$60	\$90
50 hp	\$80	\$120
Bass/Ski tracker-90 hp	\$200	\$275
Rider Towable	\$30	\$40
Floating Pad	\$40	\$50



Veranda Pontoon Boat-40 hp	\$175	\$250
Sun tracker Pontoon-115 hp	\$200	\$300



Jet Ski	\$175	\$250
2 Jet Skis	\$275	\$350

(Cleaning/Damage Deposit of \$200.00 each)



TRUCKS AND TRAILERS

(\$200 truck deposit) DAILY (Mon-Fri) SAT-SUN

3/4 Ton Quad Cab Truck	\$75	\$130
\$200 Cleaning/Damage Deposit; 300 miles a day, .25 per additional mile.		
16' Box Moving Truck	\$75	\$120
\$200 Cleaning/Damage Deposit; 300 miles a day, .25 per additional mile.		
6" x 12' Dump Trailer	\$75	\$100
\$200 Cleaning/Damage Deposit		
5 x 8 Utility Trailer	\$25	\$35
5 x 8 Enclosed Trailer	\$40	\$70
5 x 10 Utility Trailer	\$30	\$50
6 x 12 Enclosed Trailer	\$50	\$80
4 Canoe /Kayak Trailer	\$20	\$35
6 Kayak trailer	\$25	\$40
8 Canoe /Kayak	\$30	\$50

PARTY SUPPLIES

Chair	\$1.75	\$2.75
10-chair package	\$13	\$20
Table (Round add \$1)	\$5	\$8
Table & 6 chairs package (Round add \$1)	\$13	\$20
10 X 10 Steel Frame Canopy	\$45	\$75
10 X 20 Steel Frame canopy	\$55	\$100
Add Sides for 10 x 20	\$10	\$10
BBQ Grill with trailer	\$50	\$80
Rotisserie Grill with trailer	\$45	\$75
Choice grills		
(Large)	\$60	\$100
(Medium)	\$50	\$80
Popcorn Machine	\$30	\$50
Sno-Cone Machine Syrups \$6/quart	\$35	\$60
Large Cooler	\$10	\$15
Medium Cooler	\$7	\$10

KAYAKS AND CANOES

Kayak	\$15	\$20
Double Seat Kayak	\$18	\$25
Double Seat Canoe	\$15	\$20
Three Seat Canoe	\$18	\$25
Paddle Board	\$40	\$60
Dry Bags	\$3	\$5

MISC. EQUIPMENT

	DAILY (Mon-Fri)	SAT-SUN
Misting Fan	\$30	\$50
2200Generator	\$30	\$50
3000 Generator	\$40	\$70
Propane Heater	\$35	\$60
Lawn Mower	\$35	\$60

CAMPING EQUIPMENT

Electric lantern	\$5	\$5
Propane stove	\$5	\$5
Sleeping Cot	\$5	\$5
Sleeping Bag	\$5	\$5
Sleeping Pad	\$4	\$4
Inflatable Sleeping Pad w/bag Pump	\$5	\$5
Backpack	\$4	\$4
Cook kit	\$5	\$5
4-person tent	\$10	\$18
5-person tent	\$12	\$20
6-person tent	\$14	\$24

CAMPERS

27' Coleman Lantern Camper	\$150	\$200
Requires at least 1/2 ton vehicle to pull	WEEKLY RATE: \$750	
\$200 Cleaning/Damage. Deposit required		

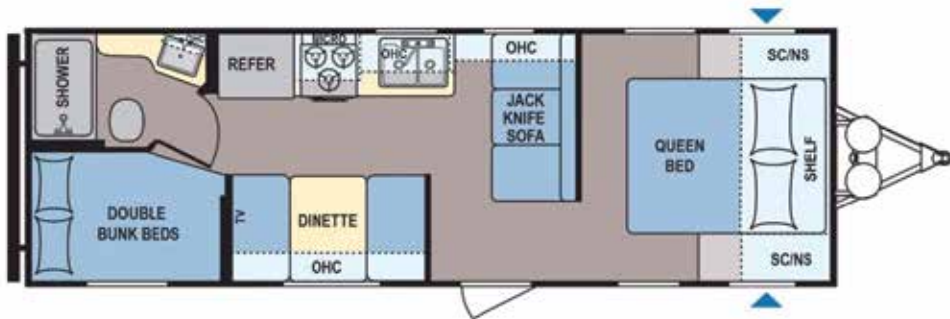

Casita Camper with A/C (16ft)	\$70	\$100
(No smoking or pets in campers)\$200 Cleaning/Damage deposit required		

PACKAGE PRICING

Truck & Coleman camper	\$200	\$300
Truck & dump trailer	\$115	\$200
Coleman camper & 3k generator	\$180	\$225
Box truck & bounce house	\$160	\$275
Truck & 6' x 12' enclosed trailer	\$115	\$200
PT mountain bikes & Trailer (22 bikes)	\$125	\$200

FOR SOLDIERS

FOR FAMILIES

FOR RETIREES

FOR CIVILIANS